



21st Annual EURēCA

Exhibition of Undergraduate
Research and Creative Achievement

2017



THE UNIVERSITY OF
TENNESSEE
KNOXVILLE

UNDERGRADUATE RESEARCH

Welcome to the University of Tennessee's 21st annual Exhibition of Undergraduate Research and Creative Achievement (EURēCA). This event celebrates original and creative works completed by undergraduate students as the highlight of Research Week events and celebrations.

The Office of Undergraduate Research coordinates this unique competition to encourage, support, and reward undergraduate participation in the campus research enterprise. By participating in campus research these students are able to develop faculty mentoring relationships, enhance their resumes, and become more competitive when applying to graduate school.

With record numbers this year we welcome over 546 students and 333 entries of their research and creativity. The diverse array of exhibits and performances highlight a broad range of endeavors and approaches. The presentations include both individual and team efforts, and represent projects pursued beyond course requirements as well as projects that illustrate the pursuit of original work in the classroom.

Generous support for this event is provided by the Office of the Chancellor and the Office of Research and Engagement. Awards were provided by colleges, departments, Phi Kappa Phi National Honor Society, and the Office of Sustainability. Also we send a big thank you to our division representatives in organizing the participants from their areas and to our judges for all of their hard work in selecting this year's winners. We are also thankful for the time and effort the library has devoted to ensuring this event is a success.

Thank you for taking the time to visit the event, speak with the students, and support the excellent undergraduate research and creativity activity at The University of Tennessee, Knoxville. If you would like to become more involved in undergraduate research, I encourage you to take advantage of our enhanced institutional membership of the Council on Undergraduate Research as well as contact our office for information on how to get started.

Sincerely,

A handwritten signature in black ink that reads "Marisa Moazen". The signature is fluid and cursive, with the first name "Marisa" and last name "Moazen" clearly distinguishable.

Marisa Moazen, Ph.D.

Director, Office of Undergraduate Research

Exhibition of Undergraduate Research and Creative Achievement 2017

Schedule of Events

Monday, April 17

5:00 p.m. – 8:00 p.m. Exhibition of Group A opens for judging and viewing

Architecture + Design; Arts & Sciences – Humanities, Social Sciences, Visual & Performing Arts; Communication and Information; Education, Health, and Human Sciences; Nursing; Social Work; and Haslam College of Business students

Tuesday, April 18

All Day Exhibitions open to the public

Wednesday, April 19

5:00 p.m. – 8:00 p.m. Exhibition of Group B opens for judging and viewing

Agricultural Sciences and Natural Resources; Arts & Sciences Natural Sciences; Engineering students

Thursday, April 20

All Day Exhibitions open to the public

6:00 p.m. – 7:30 p.m. Awards Ceremony in McClung Museum Auditorium

School of Music EURēCA Top Winner, selected at the University of Tennessee's School of Music 2017 Celebration of Excellence
Competition, performance: Brianna Terry, Saxophone

Friday, April 21

8:00 a.m. – 11:00 a.m. Posters taken down

Exhibition of Undergraduate Research and Creative Achievement

2017 Division Representatives

Suzanne Allard
Communication & Information

Christine Boake
Arts & Sciences

Sunha Choi
Social Work

George Drinnon
Business

T.K. Davis
Architecture & Design

Kimberly Gwinn
Agricultural Sciences & Natural Resources

Kevin Kit
Engineering

Andrew Skoog
Music

Cary Staples
Art

Jamia Stokes
Education, Health, & Human Sciences

Kathleen Thompson
Nursing

Gina DiSalvo
Theatre

Office of Research & Engagement

Taylor Eighmy
Vice Chancellor for Research & Engagement

Office of Undergraduate Research

Marisa Moazen
Director of Undergraduate Research

Elizabeth Nelson
Program Coordinator

Susan Troop
Administrative Assistant II

Kolin Konjura
Graduate Teaching Assistant

Sara Ramirez
Peer Mentor

Kendall Thompson
Communications

Joshua Caddell
Data Research Associate

Colleen Ryan
Peer Mentor

EURēCA

Exhibition of Undergraduate Research & Creative Achievement

This year, over 546 undergraduate students from the University of Tennessee will be presenting 333 entries of their research and creative activity at EURēCA. This research covers many different disciplines, from cinema studies to mechanical engineering to stock market studies, and are categorized into the following 11 judging divisions:

College of Agricultural Sciences and Natural Resources

College of Architecture and Design

College of Arts and Sciences

School of Art, College of Arts and Sciences

School of Music, College of Arts and Sciences

Haslam College of Business

College of Communication and Information

College of Education, Health, and Human Sciences

College of Engineering

College of Nursing

College of Social Work

Monday, April 17 & Tuesday, April 18
John C. Hodges Library 1st Floor Map

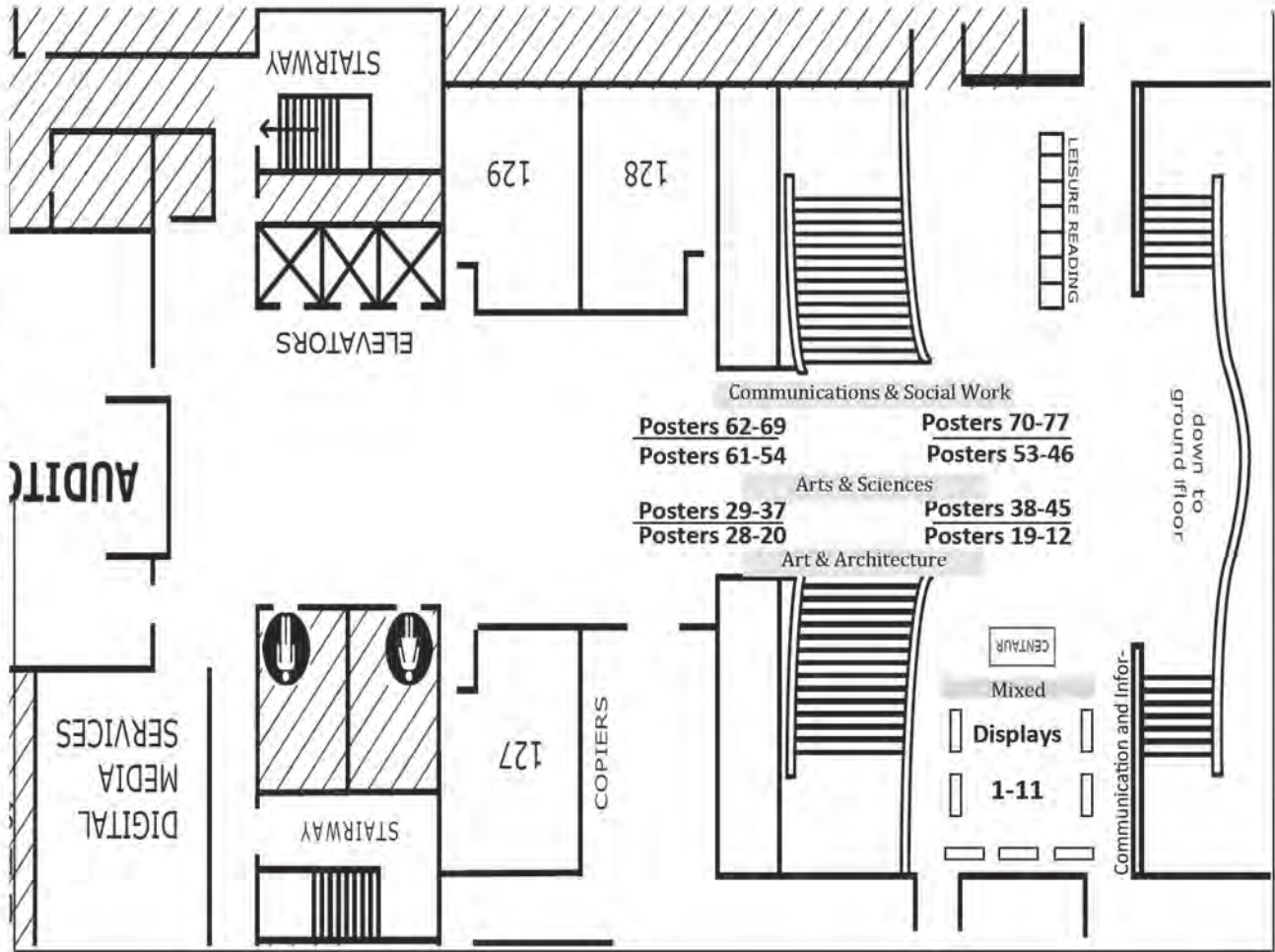

Monday, April 17 & Tuesday, April 18
John C. Hodges Library 2nd Floor Map

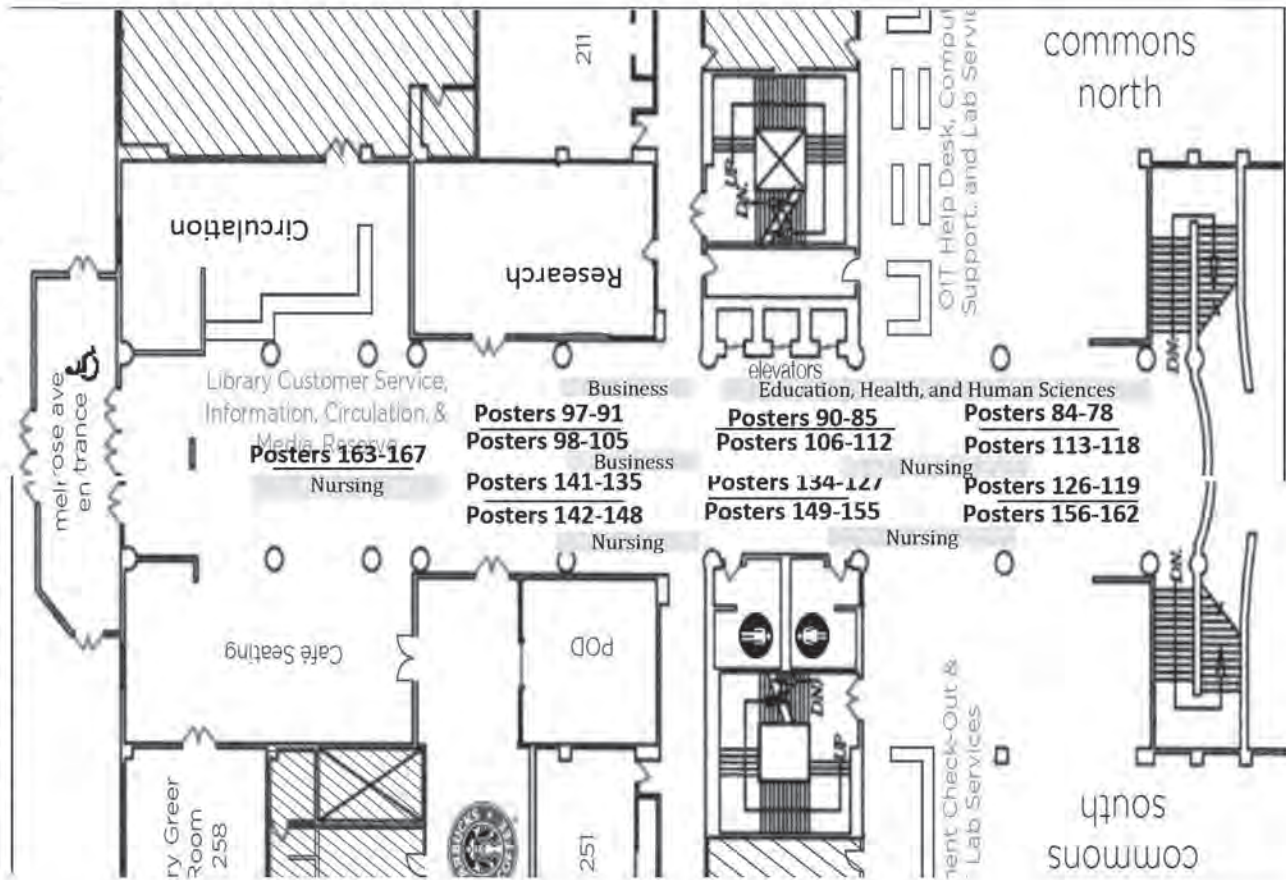

Wednesday, April 19 & Thursday, April 20
John C. Hodges Library 1st Floor Map

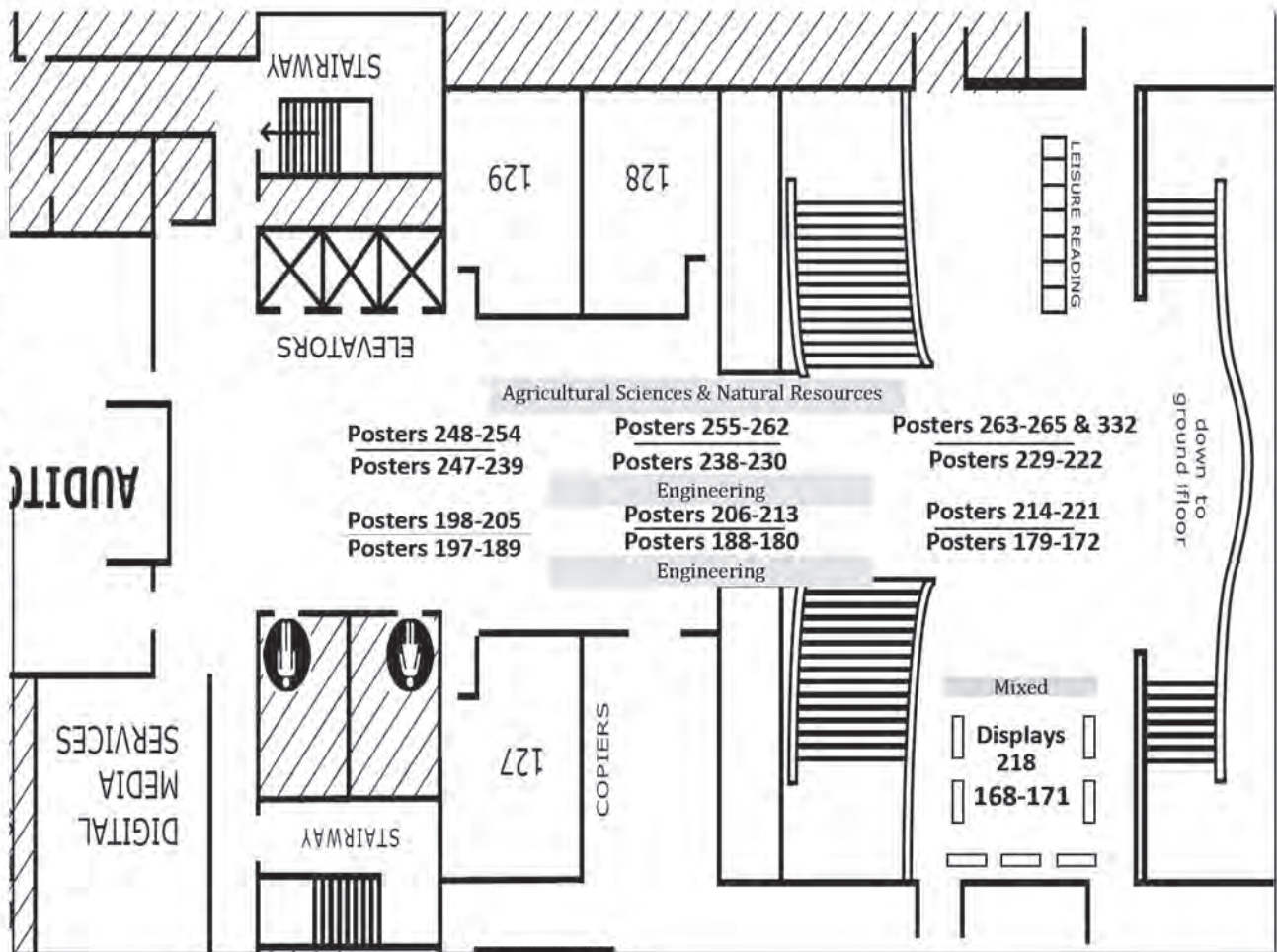

Wednesday, April 19 & Thursday, April 20
John C. Hodges Library 2nd Floor Map

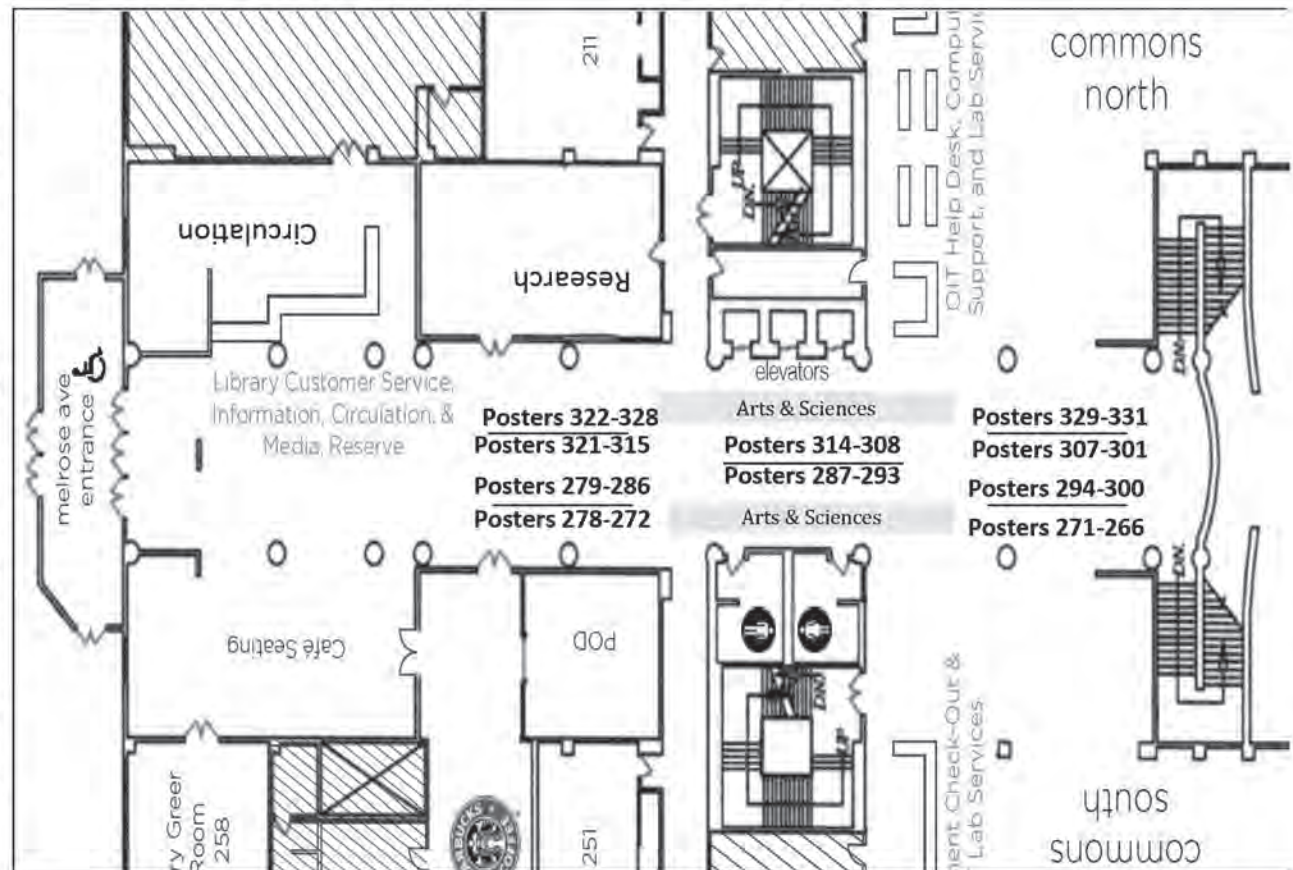

**Research Posters and Creative Works
Presented on Monday, April 17 & Tuesday, April 18**

School of Art, College of Arts & Sciences				
Poster #	Student Name	Major	Title	Faculty Mentor
1	Jayson E Alexander	Graphic Design	Go... Outside?	Staples, Carolyn I
2	Joseph Grant Barbour	Studio Art	Bubble Boy and His Rooms	Murphy-Price, Althea Martina
3	Zachary Jackson Edwards	Fine Arts,Sculpture	One-Way: A Sound Installation	Ann, Jessica
4	Sam E Hansen	Graphic Design	Hip-Hop's Most Intelligent MC's	Staples, Carolyn I
5	Margaret Jane Moore, Jordan Katherine Beets	Graphic Design	Sneaker Popularity Study	Staples, Carolyn I
6	Elise Camille Stephens	Art	Creative Collaboration: Exploring the Aesthetics of Bridging Music and Art with Code	Variego, Jorge
7	Jonathan Andrew Young	Graphic Design	Bonne Chance, Animation in App Development	Staples, Carolyn I
8	Alex Ring Gray, Wesley James Fowler	Music Theory & Composition	Interactive Learning: The Sounds of "Bonne Chance"	Staples, Carolyn I
12	Jordan Katherine Beets	Graphic Design	Evolution of the Sneaker Culture	Staples, Carolyn I
13	Adelaide E Davis, Cameron Spooner	Graphic Design	Normalizing Disability Through Design	Staples, Carolyn I
14	Rachel Gorman	Graphic Design	Visualizing the Stigma of Mental Illness	Staples, Carolyn I
15	Alisa K Harvey	Graphic Design	Folk Tales	Staples, Carolyn I
16	Caleb Lester Jones	Graphic Design	The Push for Success in School Age Sports	Staples, Carolyn I
17	Thomas Ryan Murr	Graphic Design	Large Format Film Photography	Lee, Paul P
18	Layla Elizabeth Nami	Graphic Design	Analysis of the factors that influence music preference	Staples, Carolyn I
19	Jack Westphal Petschulat	Graphic Design	Broken Bottles	Staples, Carolyn I
20	Sierra Renee Plese	Graphic Design	Bonne Chance Project Data Transfer	Staples, Carolyn I
21	Sierra Renee Plese	Graphic Design	Visualization of Research on Homeless Veterans	Staples, Carolyn I
22	Timothy Sengaroun	Graphic Design	Bonne Chance	Staples, Carolyn I
23	Laurel Kathryn Tyree	Graphic Design	The Impact of The White Helmets In Syria	Staples, Carolyn I
24	Lian Jye Yuan	Graphic Design	Is College the only option?	Staples, Carolyn I

College of Architecture and Design				
Poster #	Student Name	Major	Title	Faculty Mentor
9	Macy Belle McCarty Camille Elizabeth Lane	Architecture	Disembodied Circle: A Twelve-Step Program	Ambroziak, Brian Michael
10	Graham Colton Taylor Joshua Alexander Murray, Casey David Myers	Architecture	TVA Headquarters: Poetics of Constraint	Rose, James Richard
25	Kimberlee Lauren Ballard Torie Ann Buche, Sierra Denise Holder	Architecture	Mini XP	Goeritz, Hansjoerg
26	Sydney Ann Bittinger Emily R Gowder	Architecture	Salk Institute	Goeritz, Hansjoerg
27	Rachel Christiane Elbon Adam Jesse Smith	Architecture	Urban Quarter Organics	Stevens, Kevin
28	Margaret Ellen Marie House	Architecture	Identity of Scatter	Stuth, Tricia Anne
29	John C Huddleston Leah Noel Cassetty	Architecture	Unite d'habitation	Davis, Marleen Kay
30	Michael Steven Lidwin Rachel Kathlyn List	Architecture	Investigating Terracotta Cladding - An Analysis of the Bechtler Museum's Enclosure	Goeritz, Hansjoerg
31	Elizabeth D Ott	Architecture	Vessels of Relief	Moir-Mcclean, Tracy W
32	Allison Morgan Sonnenberg	Architecture	Urban Revitalization and Environmentally Conscious Architecture: The Tennessee Concrete Association's New Headquarters	Davis, Thomas K
33	Jonathan William Winfield Emily R Gowder	Architecture	Pictorial Inscription	Ambroziak, A Katherine Bambrick
34	Makenna Breann Wood	Interior Architecture	The Oasis	Teston, Liz

Humanities, College of Arts & Sciences				
Poster #	Student Name	Major	Title	Faculty Mentor
35	Austin Alan Burnett	History	The U.S. Constitution as a Military Document: How can "Power to the Many" lead to Instability? 1776-1789	Magra, Christopher Pa
36	Tiffany Nichole Cantrell	History	Did UT's college girls participate in the Rampant Culture of Prostitution in Knoxville in the 1950s? A Look at the Economic and Social causes of "Pickup Dating" among College Girls.	Sacco, Lynn Ann
37	Beth Anne Clayton	Linguistics	The Perception of Unmarked Appalachian English	Grieser, Jessica Ann
38	Cayla Briann Colclasure	Anthropology	Lasting Impressions: Distributional Analyses of Features and Artifacts from the Topper Site (38AL23)	Anderson, David George
39	Savannah Dixon Simone A Yates, Kelsey E Waterson	Hispanic Studies	The History of Mayan Resilience as Seen in the Indigenous Language, Particularly K'iche'	Gimmel, Millie
40	lessandra Elisabetta Ferrero	Religious Studies	The Impact of Bread Production on Women's Roles in the Book of Leviticus	Darby, Erin Danielle
41	Erika Rene Knowles	Russian Studies	Tolstoy, Shklovsky, and the Image of Creativity in Nabokov	Blackwell, Stephen H
42	Bianca Christine Ortiz Bianca Christine Ortiz	Linguistics	Cross-Generational study of the social implications of the discourse marker 'like'	Grieser, Jessica Ann
43	Gretchen Lorena Roberts Carly Ann Chwat, Peter Lawrence Ignacio, Victoria Gail Vanmaaren, Stephanie Krider Daniels, Madeline Birch Auge, Janet Elaine Schwartz-Micheaux	Psychology	Influence of College Pen Pal Program on Fourth Grade Writing Attitudes	McCurdy, Merilee
44	Kirsten Salonga	Biology	The Children's Book of World Religions	Scott, Rachel
45	William Wesley White	English	Crip and Queer: The Heroism of Katrin in Brecht's Mother Courage and her Children	Anderson, Misty G

Social Sciences, College of Arts & Sciences				
Poster #	Student Name	Major	Title	Faculty Mentor
11	Caitlin Emily Myers	College Scholars Program	Power Lines: Perspectives on Broadband and Inequality in Rural East Tennessee	Gellert, Paul Kenneth
46	Darcy A Ayers	Anthropology	Validating Geospatial Analysis with Community Risk Perception Survey in Big Island, Hawaii	Swamy, Raja Harish
47	Jama Bettis	Psychology	Anxiety and Cognition	Bolden, Jenn
48	Pete Michael Cates	English	Indigenous Rhetorics in Quebec's Education System	King, Lisa Michelle
49	Holly Flatt Kriston Laadan Ramsey, Andrea Benavides	Interdisciplinary Programs	How short term mindfulness training affects emotional regulation on college students.	Bolden, Jenn
50	Andrea M Gorrondona	Psychology	The Relationship Between Perceived Acceptance, Depressive Symptomology, and Commitment Among Couples	Gordon, Kristina Coop
51	Leanza Greenlee	Psychology	Temperament's Effect on Interactional Synchrony	Shteynberg, Garriy
52	Nicholas Ross Harp Shichie Joyce Kuribayashi, Claire Rebecca Myrick, Nicholas Alvaro Coles	Psychology	How Are You Feeling? An Examination of an Indirect Measure of Emotional States	Larsen, Jeff T
53	Johanna Grace Lohman	Linguistics	The Role of Statistics in Infant Word Learning	Hay, Jessica Sari
54	Fiona Martin	Interdisciplinary Programs	The Impact of Gendered Design on Social Robotics	Van Riemsdijk, Micheline
55	Hannah Gabrielle Mitchell	Psychology	The Effect of Being Overweight on ER Positive Breast Cancer	Roberson, Patricia
56	Brock Holden Partlow Melanie Anne Jacobson, Jessica Lynn Anderson, Jonathan Parks Fillauer	Psychology	Anxiety's Relationship with Academic Performance	Bolden, Jenn
57	Chesnea A Skeen	Geography	Tornado Watch and Warning Understanding in Tennessee Counties	Ellis, Kelsey

58	Aubrey Hope Southerland	Psychology	The Social and Demographic Factors of ER Positive Breast Cancer Medication Adherence	Roberson, Patricia
59	Elizabeth Hope Stanfield	Geography	"I'm from here": Immigration politics and urban livability in Copenhagen, Denmark	Van Riemsdijk, Micheline
60	Kierra N Toney Amanda Brooke Adams, Tiffany Nichole Cantrell, Maygen E Lee, Jennifer Steinmann	Sociology	Parker Academy Research Project	Boyd, Karen
61	Charles Earles	College Scholars Honors	Project or Presentation Title: Rural Kenyans' views on healthcare, nutrition, and foreign medical providers	Baldwin, Debora
62	Sara Poarch	Anthropology	Beyond Voluntourism: Sustainable International Service Learning and Field School Pedagogy at 'Ayn Gharandal, Jordan	Darby, Erin
63	Mary Grace Reynolds	Political Science	Captured: Federal Financial Regulation and Income Inequality	Keller, Eric

Haslam College of Business				
Poster #	Student Name	Major	Title	Faculty Mentor
93	Eric Benjamin Alley	Economics	Business Plan	Graves, Thomas Houston
94	Caitlin Michelle Boone	Logistics & Transportation	Starbucks: In the News	Mollenkopf, Diane A
95	Savannah Bailey Callaghan	Marketing	Hard at Work or Hardly Working? Examining the Relationship Between Fun at Work and Employee Engagement	Barksdale, Cheryl
96	Hannah Myers Dunbar	Economics	Aligning Tennessee: An Analysis of Nonprofits' Perceptions of Collaboration in East Tennessee	Miller, Alex
97	Charles Whitley Emerson	Accounting	The Consequences of Humanitarian Regulation: Evidence from Dodd Frank 1502	Henry, Erin Emily
98	Mikhail Ladhani Emmanuel	Supply Chain Management	DemoCart	Youngs, Lynn
99	Troy N Galyon	Economics	SeaBangla	Graves, Thomas Houston

100	Julia Ganns	Accounting	Ride Share App for the University of Tennessee, Knoxville	Graves, Thomas Houston
101	William Gass	Accounting	The Business Grind	Bell, John Edward
102	Laura Elizabeth Hirt	Business Analytics	Does Increased Globalization Improve Citizens' Quality of Life?	Holladay, James Scott
103	Taylor Leighann King	Business Analytics	reINVENT the Way You Think About Recycling	Gras, David Michael
104	Bradley Ross Landenberger	Business Analytics	Knoxville Creative Co-working Space	Graves, Thomas Houston
105	Tucker P McLain	Accounting	Oh, the Places You'll Go!	Adeleye, Ifedapo Lanrewaju
106	Adam Clay Miller	Supply Chain Management	The Feasibility and Impact of Autonomous Technology on Transportation Networks	Holcomb, Mary C
107	Mary Margaret Mobley	Supply Chain Management	Head Over Heels: Women in Supply Chain Management	Mollenkopf, Diane A
108	Kathryn Elizabeth Pepperman	Supply Chain Management	Sustainable Value Creation for Consumers at the Base of the Pyramid	Tate, Wendy
109	Eric Stephen Peters	Economics	An Inquiry into the Effect of the 2014 Russian Sanctions on the European Gasoline Market	Murray, Matthew
110	Abigail Mary Rozanski	Accounting	Corporate Political Activity, CEO Hubris, and Earnings Management	Chyz, James Anthony
111	Madeline Marie Rule	Marketing	A Comparison of the Perceptions of Authenticity Between Movies, Television Shows, and Advertisements	Benjamin, Stefanie Ka
112	Elizabeth R Schofield	Marketing	Target Marketing: the Generational Differences	Schumann, David W
113	Sara Elizabeth Seaman	Business Analytics	Trading the Pant Suit for a Paint Brush	Youngs, Lynn
114	Harrison Taylor Smith	Finance	NAFTA in Mexico	Holladay, James Scott
115	Samantha Nicole Steichen	Marketing	Is Changing Your Layout Worth The Payout? The Impact of Office Layout on Employee Wellness and Reactions	Munyon, Tim
116	Tayler Amelia Tate	Logistics & Transportation	PlentiFull Business Proposal	Youngs, Lynn
117	Matthew Stephen Wright	Marketing	Consumer Perception of Green Marketing: Exploring consumers' trust in claims of sustainability	Zablah, Alex R
118	Rani Hani Zaouk	Finance	An Activities Analysis of Executive Time Allocation	Smith, Anne D

College of Education, Health, and Human Sciences				
Poster #	Student Name	Major	Title	Faculty Mentor
78	Rebecca Zuchowski Cepeda	Nutrition	Maternal and Infant Factors Associated with Spit-Up Estimation Accuracy	Kavanagh, Katie
79	Tory Danielle Frankel	Nutrition	Effects of Zyflamend Treatment on Adipogenesis	Bettaieb, Ahmed
80	Taylor Marie Harris	Nutrition	The Combination of Dietary Zyflamend+WholeMega Fatty Acid Supplementation Inhibits Intimal Hyperplasia	Whelan, Jay
81	Kathleen Ann Mcinnis	Kinesiology	Experiences of female high-school head coaches	Dzikus, Lars
82	Ashley Nicole Northcutt	Nutrition	Prevalence of Adolescents meeting Well-Child and Dental Preventative Care Recommendations in one High School	Colby, Sarah Elizabeth
83	Brenna Brigid O'Malley	Nutrition	Soluble epoxide hydrolase inhibitor t-TUCB promotes brown adipogenesis	Zhao, Ling
84	Abigail Diana Owens	Nutrition	Adolescent Choline Supplementation Mitigates the Effects of Adolescent Stress	Schulz, Kalynn Marie
85	Megan Louise Pence	Nutrition	Disruption of Pyruvate Kinase M2 expression in the pancreas affects β -cell function	Bettaieb, Ahmed
86	Whitney Lynn Pittman Damla Sarisaltik	Kinesiology	Sources of Error in Wearable Step Counters	Bassett Jr, David R
87	Haley Noel Porter	Kinesiology	How Colonocyte Metabolism Shifts in Colorectal Cancer	Donohoe, Dallas
88	Dexter Lee Puckett	Nutrition	Improved glycemic control in mice with specific deletion of Pyruvate kinase M2 in the pancreas	Bettaieb, Ahmed
89	Beverly M Samples	Nutrition	2DG Decreases Butyrate's Ability to Function as an HDAC Inhibitor in Colon Cancer Cells	Donohoe, Dallas
90	Ethan Schaltegger	Kinesiology	Towards Adapting Flexible Nonlinear Periodization for Untrained Adults: Exploring Perceptions of Aerobic Exercise Demand	Strohacker, Kelley Amanda

91	Lucas Forrest Sheridan	Statistics-Arts & Sciences	Using an Online Survey Distribution Platform to Conduct Ecological Momentary Assessment of Exercise Antecedents: A Feasibility Study	Strohacker, Kelley Amanda
92	Cynthia Michele Standifer	Nutrition	A Deficiency in Pyruvate Kinase M2 Has Anti-Obesity Implications Through Making White Adipocytes Look and Behave Like Brown Adipocytes	Bettaieb, Ahmed

College of Nursing				
Poster #	Student Name	Major	Title	Faculty Mentor
119	Emeri Kaitlin Allan	Nursing	Assessing the impact of animal-assisted interventions on patients in the clinical setting	Elliott, Lizanne Munson
120	Sloan Taylor Bennett Robert Darold Land, Isabel Elise Cartwright, Elizabeth Alice Jenner	Nursing	Compliance with Personal Protective Equipment	Thompson, Kathleen
121	Lauren Taylor Bolek Lauren Marie Lovell, Su Mei Chin, Sara Church	Nursing	Self-care strategies for nurses: Relaxation and meditation techniques for stress reduction and the prevention of burnout	Thompson, Kathleen
122	Sarah Elizabeth Boop Alison Veronique Dawant, Leslie Elaine Watts, Taylor Harris	Nursing	Comparing Policy to Best Practice: Family Presence During Resuscitation	Thompson, Kathleen
123	Marlisa Linda Brasfield Lindsay Marie Ammerman	Nursing	Factors Contributing to Sudden Infant Death Syndrome	Thompson, Kathleen
124	Tanya Bueter Brady Scott Brown, Gabriel Reed Archer, Sallie Jean Ware	Nursing	CPR Training Method Review	Thompson, Kathleen
125	Michael J Curtis	Nursing	The voices of photos: Transition to adulthood in lower income emerging adults with Type I Diabetes Mellitus	Abdoli, Samereh
126	Anne-Katherine K Darroch Brenna Hope McMackin, Kaitlyn Jolie Hillstead	Nursing	Safe Patient Handling to Prevent Nurse Injury	Thompson, Kathleen

127	Rhian Victoria Dougherty Hannah E Raines, Katherine Claire Vance	Nursing	Effectiveness of Current Interventions on Preventing Hospital Acquired Pressure Ulcers (HAPUs)	Thompson, Kathleen
128	Dylan Martin Foster Corey Thomas Kocisko, Dylan Martin Foster, Heather A Mackenzie	Nursing	Catheter Associated Urinary Tract Infection Prevention	Thompson, Kathleen
129	Maraya Hope Fitcher Sadie Amelia Lett, Lucia Louise Chalmers, Lauren Elizabeth Love	Nursing	Alarm Fatigue: Methods to Decrease to Improve Patient Safety	Thompson, Kathleen
130	Julia E Garland Haleigh Caitlyn Meyer, Antasia Brianna Burrow	Nursing	The Effects of Transformational Leadership by Nurse Managers on Nurse Turnover	Swift, Shelia Henson
131	Rachel Lynne Garson Natalie Adiam Walker, Elisabeth Anne Pitt, Evelyn Kouzov	Nursing	The effectiveness of the sterile cockpit method in mitigating medication areas in the hospital	Thompson, Kathleen
132	Grace Goodwin Brian David Peterson, Hayley Ryann Goldman, Thomas Conner McCroskey	Nursing	The Effects of Fatigue on Nurses and Patient Care	Brown , Kimberly
133	Matthew Johann Grimm	Nursing	Predictive Risk Assessment Model for 30-Day Readmissions Among Heart Failure Patients in Southeast Appalachia	Thompson, Kathleen
134	Gillian P Harris	Nursing	The Psychosocial Responses to and Decision Making Strategies of Hereditary Cancer Genetic Panel Testing	Hutson, Sadie Pauline
135	Kassandra Leigh Hermanson Taylor Renee Neuharth, Jenna Marie Duerst	Nursing	Nursing Bereavement Interventions	Thompson, Kathleen
136	Hannah Ramsey Holcomb Darian Andrea Frieson, Darielle R McDonald, Jordan Ann Wilson	Nursing	The Use of Meditation and Mindfulness-Based Stress Reduction Programs in Nurses	Thompson, Kathleen
137	Marielle Lynn Holtzclaw Caroline Elizabeth Macrae, Brianna Kaitlyn Pike, Carly Joanne Ross	Nursing	Kangaroo Care and the Effect on Mother-Baby Bonding	Thompson, Kathleen
138	Halli Koger Hannah Chistenson, Ellen Christine Dailey	Nursing	Evaluating Effectiveness of Different Distraction Techniques Among Pediatric Patients	Thompson, Kathleen

139	Malerie R Lazar	Nursing	The Meaning of Access to Care for Persons with a Low Family Income: A Phenomenological Approach.	Davenport, Lisa
140	Amanda Leigh Letsinger Madalyn Leigh Burke, Jessie Lynn O'Rear, Rachel Lauren Newton	Nursing	Transmission of Infection associated with Healthcare Providers' Stethoscopes	Thompson, Kathleen
141	Chelsea Alia Lewis Sydney Macey Incorvaia, Hannah Elizabeth Cassetty, Emily Kathleen McHugh	Nursing	The Use of Music Therapy to Decrease the Agitation of Patients with Dementia	Thompson, Kathleen
142	Claire Liana Nicole Lutzak Kennedy R Brabston, Lauren Marie Woods, Kelsey M Bivacca	Nursing	The Efficiency of Multidisciplinary Interventions to Prevent Pressure Ulcers	Thompson, Kathleen
143	Sarah Douglas McCall Shannon Caroline Boyer, Sarah Schaffer Hardesty, Courtney Paige Rhodes	Nursing	The Importance of Nonpharmacological Interventions in the Treatment of Neonatal Abstinence Syndrome	Thompson, Kathleen
144	Briana Kymari McIntyre Savannah Camille Clay, Valeria Sanabria-Sugarman	Nursing	Yoga and its Impact on Stress and Anxiety	Thompson, Kathleen
145	Sarah Ann Mihealsick Molly Ann Faust, Samuel James Deford	Nursing	Strategies of Vaccination Promotion Methods in School-Aged Children	Thompson, Kathleen
146	Lindsey Estellan Miles Kerrin Nicole Boullie, Tori Alexandra Patterson, Alexandra L Koenig,	Nursing	Interventions to Reduce Medication Administration Errors (MAEs)	Thompson, Kathleen
147	Chase Aaron Miller Alex Ryan Bacon, Timothy H Ivy	Nursing	Music Therapy and Cancer Pain	Thompson, Kathleen
148	Rachel E Poppert Benjamin Aaron Vanderford, Cassandra Jayne Williams	Nursing	A Comparison of Alternative Therapies for the treatment of Opioid Addiction	Thompson, Kathleen
149	Stephanie Sharon Nabors	Nursing	A Literature Review of Substance Abuse Among Anesthesia Providers	Bonom, Julie Newton
150	Madison McKinsey Patterson	Nursing	Staff Nurse Perceptions of Their Role in Hospital Reimbursement via Nursing Sensitive Indicators and Patient Satisfaction	Swift, Shelia Henson

151	Abigail Elisabeth Pirie Cole Jenkins Spencer, Mallory Cameron Mccullough, Ellen Maxwell	Nursing	Decreasing Cesarean Births After Epidural Administration	Thompson, Kathleen
152	David Quillin Megan Elaine Cross, Dena Stansberry Charles	Nursing	Childbirth Pain and Non- Pharmaceutical Interventions	Thompson, Kathleen
153	Mollie Elizabeth Ray Natalie Blair Grossman, Jacqueline Greer Fitzgerald	Nursing	Social Media Influence on Parental Vaccination Decisions	Thompson, Kathleen
154	Caroline A Rhea	Nursing	The Effects of Decontamination of Stethoscopes on the Rates of Hospital Acquired Infections	Thompson, Kathleen
155	Shauna Lynn Sells Suzanne R Johnson, Tawayne Jodie Tucker, Samantha Jade Driskell	Nursing	Prevention of healthcare- associated infections through daily patient bathing with chlorhexidine gluconate	Thompson, Kathleen
156	Kate Richter Shult Erica Sowell, Katherine Satterfield, Casey Shaw	Nursing	Kangaroo Care in the NICU	Thompson, Kathleen
157	Chelsea V Smith	Nursing	Parental knowledge of Adverse Childhood Events and the effect on health and substance abuse disorders	Davis, Sharon Keck
158	Starla Mikel Smith	Nursing	Emotional Coping for Fibromyalgia	Anderson, Joel Gwyn
159	Whitney Lynn Stone	Nursing	Recreated Culturally Acceptable Advance Directive for Persons Experiencing Homelessness	Mixer, Sandy
160	Kelsey Brook Towe Holli Joelle Barnes, Kaylee Karay Brace	Nursing	Reducing Medication Errors: Exploration of Double- Checking and Sterile Cockpit Methods	Bodiford, Shannon Renee
161	Adaya Alexandra Troyer	Nursing	Preschool Children: What they know about asthma and how they learn	Wyatt, Tami Hodges
162	Morgan Brooke Vantrease	Nursing	The Effects of Cuddling in Neonatal Abstinence Syndrome	Chyka, Deb
163	Amy Marie Watkins Olivia Danielle Looney, Claire Anne Bianconi, Jamie Simmons	Nursing	Effectiveness of Music Therapy on Pain Reduction in Adult Cancer Patients	Acres-Natelson, Laurie Lu

164	Lauren Ashley Whited	Nursing	Effects of Music Therapy in Minimizing Depression in the Elderly	Thompson, Kathleen
165	Kathleen Krenson Wilson Elizabeth Grace Seal, Peyton Renee Maddux, Sarah Elizabeth Balkon, Leah E Anderson	Nursing	Evaluating Methods to Overcome Language Barriers in Spanish-Speaking Patients	Thompson, Kathleen
166	Hannah G Yoder	Nursing	Exploring Black Women's perceptions of midwifery and antenatal care in Knoxville	Hutson, Sadie Pauline
167	Sydney Mackane York Chelsea Marie Hancock, Hannah F Ledbetter, Palmer Elizabeth Gleason	Nursing	The Evaluation of Nonpharmacological Interventions With Neonatal Abstinence Syndrome	Thompson, Kathleen
333	Megan Kay Borgmier	Nursing	Distress of Parents of Nicu Graduates	Thompson, Kathleen

College of Social Work				
Poster #	Student Name	Major	Title	Faculty Mentor
67	Hope Anthony	Social Work	Effectiveness of the CLO's After School Program	Choi, Sunha
68	Abigail Morgan Booher	Social Work	Substance Abuse in Rural Communities and its Connection to The Child Welfare System	Choi, Sunha
69	Roxanne Baker De Guzman	Social Work	Keys to Success: An Evaluation of the YWCA Keys of Hope Women's Housing Program	Choi, Sunha
70	Christina Haley Emitt	Social Work	Dialectical Behavior Therapy for Clients with Major Depressive Disorder and Bipolar I Disorder	Choi, Sunha
71	Denise Elizabeth Harris	Social Work	Factors that Influence Job Satisfaction for Child Welfare Case Workers	Choi, Sunha
72	Holly Keeble Hill	Social Work	Perceived Reasons for Homelessness and Perceived Barriers to Overcoming Homelessness	Choi, Sunha
73	Dallas Bailey King	Social Work	Exposing Gaps in Post-care Needs for All Amputees	Choi, Sunha

74	Lauren Scott Mohler	Social Work	Impact of New Policy's Requirement on Individuals in the Intellectually Disabled Population	Choi, Sunha
75	Emma Jon Phillips	Social Work	Factors Associated with Successful Completion of an Intensive Long-Term Support Mental Health Treatment Program	Choi, Sunha
76	Rachel LEEanne Stanley	Social Work	Research Analysis: Positive Implications of Animal-Assisted Interventions with "At-Risk" Adolescents in the Program H.A.L.T	Choi, Sunha
77	Julia Laine Allison	Social Work	Social support and mothers' perceptions of parenting difficulties among the Gamo people in Southern Ethiopia	Fouts, Hillary

College of Communication and Information				
Poster #	Student Name	Major	Title	Faculty Mentor
64	Clint Garrison Graves	Communication Studies	Disclosure Patterns among Gynecologic Patients	Violanti, Michelle T
65	Alexandra Adrienne Nelson Karlie June Crawford, Leah Elaine French, Elizabeth Tennessee Davis, Christopher J Stovall	Communication Studies	The Influence of Cultural Dimensions on Conflict Communication Patterns	Violanti, Michelle T
66	Katie Danielle Scott	Communication Studies	HPV Vaccination Receptivity: How Provider Messaging Influences Patient Receptivity	Violanti, Michelle T

Research Posters and Creative Works

Presented on Wednesday, April 19 & Thursday, April 20

Cellular & Molecular Biology, College of Arts & Sciences				
Poster #	Student Name	Major	Title	Faculty Mentor
266	Evalynn Chassity Borrego	Biomedical Engineering	Characterization of Growth Rate of Closely Related Escherichia Coli Strains	Mannik, Jaan
267	Alexandra Ruth Buccelli	Psychology	Family and Genetic History for ER+ Breast Cancer Patients: A Replication in Appalachia	Roberson, Patricia
268	Robert Ethan Burks	Microbiology	Investigating the Role of SB-224289 On Yeast Membrane Dynamics	Reynolds, Todd B
269	Esther Heewon Choo	Anthropology	The presence of various spinal joint diseases and its correlations to age and sex	Steadman, Dawnie Wolf
270	James Postell Clark	Microbiology	Exploration of Streptomyces activity with bacteria and fungi	Reynolds, Todd
271	Madeline M Davis	Biological Sciences	Intracellular Transport: The Role of Class XI Myosins in Organelle Movement and Root Hair Growth in Arabidopsis thaliana	Nebenfuehr, Andreas
272	Mark R Edens	Biochem/Cellular/ Molecular Biology	Susceptibility of A. thaliana with varying TGG1 expression to H. schachtii nematode infection	Burch-Smith, Tessa Maureen
273	Nekiaya L Elam	Biology	Virus-Induced Gene Silencing of TAT1 in Nicotiana benthamiana	Burch-Smith, Tessa Maureen
274	David Leighty Grant	Biological Sciences	Identification of Streptomyces isolate-specific secondary metabolites capable of influencing Arabidopsis thaliana root microbiome establishment	Lebeis, Sarah
275	Jeremiah Ray Holt	Biochem/Cellular/ Molecular Biology	Genetic and molecular characterization of Arabidopsis thaliana eukaryotic initiation factor (eIF)2 β	Vonarnim, Albrecht G

276	Haylie Rachel Lam Abbigail Elizabeth Stidham	Biochem/Cellular/ Molecular Biology	Screening for Novel Anti-apoptotic Factors in Neurons of <i>Drosophila melanogaster</i>	Park, Jae H
277	Madison Kathleen Leonard	Biological Science	MD structural analysis of \pm -Synuclein's NAC region under ionic conditions	Smith, Jeremy Christopher
278	Madison Kathleen Leonard	Biological Science	Circadian clock and ROS homeostasis control GCN2 dependent phosphorylation of <i>Arabidopsis thaliana</i> eif2 α	Albrecht VonArnim
279	Emily Jean Miller	Biochem/Cellular/ Molecular Biology	TMM as a GPI-Anchored Protein in Stomatal Formation	Shpak, Elena D
280	Darrian Ginae Nash Peyton Hamilton Terry, Jeffrey Schoondyke	Biochem/Cellular/ Molecular Biology	Histone deacetylase inhibitors may inhibit cancer cell migration by blocking genome compaction	McCord, Rachel Patton
281	Thao Thi Nguyen	Biochem/Cellular/ Molecular Biology	Analyzing Binding Affinity of <i>Thermosynechococcus elongatus</i> BP-1 Ferredoxin mutants with Photosystem I by chemical crosslinking	Bruce, Barry D
282	Clayton H Nunn	Biochem/Cellular/ Molecular Biology	Sub-cellular Localization of <i>Arabidopsis thaliana</i> NIP2;1 Major Intrinsic Protein, and its Effects on Hypoxia Induced Survivability	Roberts, Daniel M
283	Ilkyu Park Robert Russell Schell	Biochem/Cellular/ Molecular Biology	Insulin-like Peptides Discovered in Flies via Gene Cloning	Park, Jae H
284	Preston David Perry	Biochem/Cellular/ Molecular Biology	Abiotic stress response in <i>Nicotiana benthamiana</i> plants overexpressing chloroplast-resident RNA helicase INCREASED SIZE EXCLUSION LIMIT (ISE2)	Burch-Smith, Tessa Maureen
285	Erika Nicole Sanders	Biological Sciences	IDENTIFICATION OF A GENERAL TARGETING MOTIF GUIDING INTERACTION BETWEEN NUCLEAR-ENCODED PLASTID PRECURSORS AND THE TRANSLOCON OF THE PLASTID OUTER MEMBRANE.	Bruce, Barry D
286	Phoebe Catherine Stark	Biochem/Cellular/ Molecular Biology	The effect of 2B4 deficiency on T-cell differentiation and transplant rejection.	Alexandre, Gladys
287	Avery N Sukienik	Biochem/Cellular/ Molecular Biology	Myosin XI Isoforms: Role in the Plant Cold Response	Nebenfuehr, Andreas

288	Carolyn R Ware	Biological Sciences	Interactions of Trehalose with Model Folate Compounds	Howell, Elizabeth E
289	Brooke M Welch Kaitlyn Lee Wright, Haley E Wilder, Tori Renee Richardson	Psychology	The Side Effects of Estrogen Inhibiting Medication and the Links to Family Research	Roberson, Patricia
290	Ian Andrew Windham	Biology	Examining the role of myosin XI-I in nuclear shape and position in <i>A. thaliana</i>	Nebenfuehr, Andreas

Ecology & Evolutionary Biology, College of Arts & Sciences				
Poster #	Student Name	Major	Title	Faculty Mentor
291	Jenna Rae Davis	Geography	Comparison of Field Sampled Trends of US Dryland NPP to Spatially Extensive Satellite Data	Washington-Allen, Robert
292	Abigail Amina Edwards	Biology	Evidence for the priming effect in single strains and simplified communities of estuarine bacteria	Buchan, Alison
293	Collin Brice Fedak Michael Franklin Lannom, Jennifer Elizabeth Bauer	Geology and Environmental Study	Late Mississippian Community Assemblages in the Illinois and Appalachian Basins	Sumrall, Colin D
294	Miranda Morgan French	Biological Sciences	Detection of Isotope Bio-signatures in Antarctic Subglacial and Surface Sediments	Szynkiewicz, Anna
295	Sarah Rebecca Johnson	Geology and Environmental Study	Ontogenetic and Systematic Study of Eucystis (Diploporita: Echinodermata)	Sumrall, Colin D
296	Kane Alec Lawhorn	Ecology/Evolution Biology	Ant Biodiversity in Switchgrass Fields and Other Land Cover Types in the U.S.	Kwit, Charles
297	Hung Quoc Luong	Biochem/Cellular/Molecular Biology	The Effect of Environmental Gradients on <i>Populus Angustifolia</i> Growth Traits	Schweitzer, Jennifer
298	David Byrne Moore Jerry Clint Shannon	Geography	THEN AND NOW : LONG TERM LAND-USE CHANGES IMPACT BOBWHITES	Washington-Allen, Robert

299	Logan Michelle Qualls Jennifer Elizabeth Bauer	Geology	First 3D Reconstruction of Internal Hydrosphere Respiratory Structures in Fissiculate Blastoids (Echinodermata)	Sumrall, Colin D
300	Sierra Snively Roark	Anthropology	Macrobotanical Analysis of the Topper Site (38AL23)	Hollenbach, Kandace Renee
301	Kirsten Salonga Charis A Maness, Hayley Nicole Phillips	Biology	Assessing Human Body Measurements for the Golden Ratio	Ganguly, Nivedita
302	Kirsten Salonga	Biology	Metapleural Gland Secretion Methods to Assess Myrmecochory Interactions	Kwit, Charles
303	Matthew Douglas Scott	Microbiology	Seroprevalence of T. gondii infection in the Knoxville Zoo	Su, Chunlei
304	Sierra Joan Swanson	English	Observing Ant Grooming and Allogrooming Behaviors	Kwit, Charles
305	Alex Taylor Swystun Rachel Elizabeth Winstead	Biological Sciences	Quantitative Analysis of Microbial abundance within Arctic Fjord Sediments Assessed Through Direct Counting	Lloyd, Karen
306	Taylor Elizabeth Tieche	Geography	GIS Accuracy Assessment of Forested Wetland Predictive Model for TVA	Li, Yingkui
307	Robert Seth Wood	Geology	ASSESSING MICROFOSSIL TAPHONOMY WITH HIGH-RESOLUTION IMAGERY	Kah, Linda C
308	Helen Law	Biology	Dead or alive: How mycorrhizae influence survivorship of plants with neighbors	Henning, Jeremiah

Neuroscience, College of Arts & Sciences				
Poster #	Student Name	Major	Title	Faculty Mentor
309	Kimberly Summer Bress	Interdisciplinary Programs	STRESS AND SOCIAL DOMINANCE: CELLULAR MECHANISMS IN THE VENTRAL HIPPOCAMPUS	Cooper, Matthew A
310	Alexandra Claire Brito	College Scholars Program	Effects of Language Immersion vs. Classroom Exposure on Advanced French Learners: An ERP Study	Bowden, Harriet Wood
311	Ashley Victoria Campbell	Interdisciplinary Programs	Effects of Social Status on Responses to Social Defeat Stress in Female Syrian Hamsters	Cooper, Matthew A

312	Shelby Taylor Clouthier Jessica Lynn Anderson	Psychology	Neuroanatomical Differences Between Boys and Girls with Attention-Deficit/Hyperactivity Disorder: A Critical Review and Implications for Treatment	Bolden, Jenn
313	Christopher James Finotti	Interdisciplinary Programs	Choline Supplementation effects on adolescent stress	Schulz, Kalynn Marie
314	Blake Aaron Hodge	Biological Sciences	Chemosensory Among Organisms	Park, Jae H
315	Emily Southida Kounlavong Taylor Dawn Payne, Katherine Nicole West, Roxanne Lillian Puleo	Chemistry	Surface Enhanced Raman Spectroscopic Detection of Neurotransmitters	Sharma, Bhavya
316	Ann Marie Lawson Alexa Lorren Hartman	Biological Sciences	Antibody characterization in the anuran auditory system	Hall, Jim
317	Sarah Grace Grace Lebovitz	Biology	Circadian Rhythms in Matrix Metalloproteinase-2/9 Proteolytic Activity in the Suprachiasmatic Nucleus	Prosser, Rebecca A
318	Robert Paul Ledbetter	Philosophy	Does Perinatal Choline Supplementation Normalize Prenatal Stress-Induced Alterations in Basolateral Amygdala \pm Nicotinic Acetylcholine Receptor Levels?	Schulz, Kalynn Marie
319	Taryn Drew Lester	Biochem/Cellular/ Molecular Bio	Mapping the Identity of Perineuronal Net-Positive Neurons in the Whole Mouse Brain	Krishnan, Keerthi
320	Katie Marie Masters	Biological Sciences	The Interaction between Ethanol Consumption and Stress and their Effect on Brain Derived Neurotrophic Factor and Tropomyosin Receptor Kinase B Expression.	Prosser, Rebecca A
321	Amanda Lynn Maxie	Psychology	Choline as a Mitigating Factor of Stress Induced Spatial Memory Decline in the Developing Adolescent Brain	Schulz, Kalynn Marie
322	Camron Grey Midgette	Biomedical Engineering	Using an open field to measure the effects of choline on adolescent stress	Kalynn, Schulz
323	zabella Nicole Nill Gomez Ashlee Jo Tannehill	Pre-Professional Programs	Investigating fine motor behavior in female mouse model of Rett Syndrome	Krishnan, Keerthi

324	shana oltmann	Interdisciplinary Programs	Whether adolescent choline supplementation will reduce the negative effects of adolescent stress exposure on adult rats	Schulz, Kalynn Marie
325	Madison Anne Petermann	Psychology	Choline Association with Adolescent Stress in Rodents	Schulz, Kalynn Marie
326	Richard Vuong	Biological Sciences	Establishment of Olfactory Trap Assays to Measure Olfactory Perception Behavior in Drosophila melanogaster (Fruit Fly)	Park, Jae H

Physical Sciences, College of Arts & Sciences				
Poster #	Student Name	Major	Title	Faculty Mentor
327	Brandon Lynn Barker	Physics	Discontinuous Galerkin Methods in Context of Astrophysics Simulations with Nuclear Equation of State	Endeve, Eirik
328	Jesse Lee Buffaloe	Physics	Using Discontinuous Galerkin Methods to Solve the Euler Equations in Curvilinear Coordinates	Endeve, Eirik
329	Michael Franklin Lannom	Geology and Environmental Study	Using a GIS Model to Identify Outcrops Along Roadways	Washington-Allen, Robert
330	Jerry Clint Shannon David Byrne Moore	Geography	Improved sinkhole detection and mapping for Knox County, TN with LiDAR data	Li, Yingkui
331	Louis James Varriano	Physics	Neutron-mirror neutron oscillations in a residual gas environment	Kamyshkov, Yuri

Tickle College of Engineering				
Poster #	Student Name	Major	Title	Faculty Mentor
169	Elizabeth Evan Fortunato Jacob S Dixon, Kelsey Bratten Henderson	Biosystems Engineering	Phototherapy Delivery-System Design for In-Patient Rehabilitation	Yoder, Daniel

170	Max Lestat Neveau	Materials Science & Engineer	Direct Metal Write Additive Manufacturing of Rare-Earth Modified Aluminum Alloys Using Electromagnetic Heating Systems	Rios, Orlando
171	Lila Holmes Fisher Bryan Christopher Agee, Christopher Robert Smith, Shelby Woodson Smith, Curtis Ryan Broadbent	Civil Engineering	Strawberry Plains Pike : Senior Design Project	Retherford, Jenny
172	Hannah Hajdik	Aerospace Engineering	Structural performance of composite patches under low-velocity impact loading	TerMaath, Stephanie Carmella
173	Gillian Suzanne McGlothin	Aerospace Engineering	Mode I Fracture Behavior of Bisphenol-A Epoxy Resin	TerMaath, Stephanie Carmella
174	Justin Robert Kilmarx	Biomedical Engineering	Object Manipulation in a Brain-Machine Interface Robotic Platform	Zhao, Xiaopeng
175	Anna Morgan Mills	Biomedical Engineering	Fabricated Scaffold for Efficient Three-Dimensional Cell Culture	Ripp, Steven
176	Rachel Lynn Slappy	Biomedical Engineering	A Data Analytics Approach for Optimization of Hernia Mesh for Ventral Hernia Repair Through the Identification of Patient Subpopulations and the Correlation of Patient Outcomes to Implant Material	Barker, Elizabeth Diana
177	Anna Lois Young	Biomedical Engineering	Rapid high-throughput screening of dioxin-like aryl hydrocarbon receptor (AhR) agonists using an autobiotoluminescent yeast assay	Ripp, Steven
178	Dillan Lee Jackson Kolby Taylor Poteet, Matthew James Poland	Biosystems Engineering	A.D.A.M.	Wilkerson, John B
179	Grant Thomas Dilliha Jeffrey Scott Dixon	Chemical Engineering	"Engineering a Transfer Vector for Lentiviral Co- Transduction of the Bioluminescent lux Gene Cassette into Human Cells"	Ripp, Steven
180	Natasha Ghezawi	Chemical Engineering	Modifying the Pitzer Method to Calculate the Equilibrium Constant of Yttrium for Solvent Extraction	Counce, Robert M

181	Kaitlin Elizabeth Glynn Katherine Marie Yolitz	Chemical Engineering	Charge Transport and Dynamics of Confined Polymerized Ionic Liquids	Sangoro, Joshua
182	Matthew R Kubis Brandon A Wilbanks, Taylor Marie Weiskittel, Neel Jayantibhai Patel, Katherine Lynne Krouse	Chemical Engineering	Make Scents? Engineering Bacteria to Make Natural Scents from Chemical Waste	Trinh, Cong
183	Annabel Li Large	Chemical Engineering	Computer Simulations of Protein Aggregation in Minimal Membrane Models	Abel, Steven Matthew
184	Ryan Moser	Chemical Engineering	Leaching of Rare Earth Elements from Phosphogypsum using H ₂ SO ₄	Counce, Robert M
185	Jessica Marie Ossyra	Chemical Engineering	Sintering and electrical property investigation of depleted Urania samples	Meek, Thomas T
186	Tyler David Pitney	Chemical Engineering	Automation of Dielectric Spectra Analysis: Application of Big Data Techniques	Sangoro, Joshua
187	Brandon A Wilbanks	Chemical Engineering	Enabling Metabolic Pathway Selection via Growth Selection of Modular Cell	Trinh, Cong
188	Sydney Lin Adcock Anna Lynn Sparks, Eduardo Adame, Logan Scott Elliott, Lauren Elizabeth Barnette, Michael Nelson Shaw	Civil Engineering	Spring City Kayak Launch and Amenities Design Project	Retherford, Jenny
189	William R Allen Jason Chai, Maximillian Gordon Davis, Taylor Garrett Farrar, Scott Ryan Kimbro, Zachary Grant Wallen, Fangyi Tang	Civil Engineering	Pistol Creek Restoration Project	Retherford, Jenny
190	Zachariah Levi Arwood Vivek Chawla	Civil Engineering	Compressive behavior of carbon fiber vinyl ester composites for marine applications	Penumadu, Dayakar
191	David Alexander Christie Malachi Shayna Rosenfield, Andrew Charles Dacus, John Robin Hood, Ryne A Denton	Civil Engineering	senior design roadway design	Retherford, Jenny
192	Codi Joshua Drake	Civil Engineering	The development of physical structural dynamic models	Wierschem, Nicholas Edward
193	Kelli Michelle Grissom Amie Katherine Gipson, Sharon Louisa Counts, Christina Rose Sanford	Civil Engineering	Wastewater Treatment Improvements for Rush Strong Elementary School	Retherford, Jenny
194	Morgan Jenkins	Civil Engineering	Development of Experimental Database of Steel-Concrete Composite Columns	Denavit, Mark David

195	Anastasia Alexandrova Koumtcheva	Civil Engineering	An Analysis of Cyclist Safety at Railroad Crossings	Cherry, Chris R
196	Sean Patrick Lee	Civil Engineering	Interfacial Shear Strength of Carbon Fiber Composites	Penumadu, Dayakar
197	Jeremy Lee Melton Chelsey Ann Brummer	Civil Engineering	Particle Fracture and Color	Alshibli, Khalid
198	Claire Schmidt Oliver Roehl Moore, Kaitlyn Paige Patterson, Jacob E Taylor, Clayton D Barron, Bobby Jackson Bell, Angus Simon Sutherland Wilson	Civil Engineering	City of Maryville Urban Connectivity	Retherford, Jenny
199	Jaideep Thota	Civil Engineering	Gas Driven Fracture During Gas Production Using 2D Hele-Shaw Cell	Alshibli, Khalid
200	Walker Daniel Trent Giles Evan Rankin, Audrey Caroline Linn, Caleb Andrew Brownfield, Sam Medina, Jesse Ashby Johnson	Civil Engineering	Great Smoky Mountains National Park Donation Box	Retherford, Jenny
201	John Parker Mitchell	Computer Engineering	A Neuromorphic System on Chip for Control System Applications	Dean, Mark Edward
202	Kyle Jackson Goodrick	Electrical Engineering	Automated Double Pulse Test System for Switching Loss Characterization	Costinett, Daniel Jes
203	Matthew Walker Seals	Electrical Engineering	Single carbon fiber interface testing	Penumadu, Dayakar
204	Danika M Dorris	Industrial Engineering	Predicting Patients' Outcomes in Abdominal Wall Reconstruction Procedure	Khojandi, Anahita
205	Kevin R Gunckel Grant James Powell, Matthew R Currey, Benjamin Cole Pollack	Industrial Engineering	Pilot/ Flying J Truck Driver Staffing Optimization	Jin, Mingzhou
206	Megan Peck Kristen Nicole Miranda, Kalese Marsal Howse, Sami W Hijer, Gerald L Thornton	Industrial Engineering	Advanced Catalyst Systems Assembly Process Improvement Project	Jin, Mingzhou
207	Grant Powell	Industrial Engineering	Applied Convolutional Neural Networks in Analysis of Brain Waves During Sleep	Shylo, Oleg
208	Christina Lynn Cox Josh Cody Turan	Materials Science & Engineer	Lifetime Prediction of FeCrAl Alloys through Statistical Modeling and High- Temperature Cycling	Rawn, Claudia J
209	Cameron Russell Hale John William Bohling, William C Hoskins	Materials Science & Engineer	Weldability of Al0.1CoCrFeNi High Entropy Alloy	Lundin, Carl D
210	William C Hoskins	Materials Science & Engineer	Friction Hydro Pillar Processing of Graphitized Carbon Steel Components	Lundin, Carl D

211	Jesse Ashby Johnson	Materials Science & Engineer	Discovery of New Ternary Compounds and Scintillators of the A4BX6 Family	Melcher, Chuck
212	Alyssa M Lindsey	Materials Science & Engineer	The Applications of Atomic Structure Modeling Software in Predicting the Placement of Atoms in Scintillator Crystal Structure.	Melcher, Chuck
213	Daniel Joseph Rutstrom	Materials Science & Engineer	Investigating Activators for Potential Novel Scintillator LaI3	Zhuravleva, Mariya
214	Noah Schaftlein	Materials Science & Engineer	Pixelated Study of KCaI3:Eu 0.5%	Melcher, Chuck
215	Sabrina Emerson Amy Schwerzler	Materials Science & Engineer	Sol-Gel Synthesis and Cation Doping of Ca12Al14O33 Nanocages	Rawn, Claudia J
216	Alec Affolter	Materials Science and Engineering	Crystal Mineral Synthesis: Anorthite and Microquartz	Brown, Claudia
217	Leegan M Boudreau	Mechanical Engineering	Developing an Experimental Setup to Study the Fluid Dynamics in Ventricular Catheters	TerMaath, Stephanie Carmella
218	Jake Allen Childs Jarrod Kenderick Nachtrab, Austin Conley, Jason S. Seinfeld	Mechanical Engineering	A Drill Guide Stabilization System for Acromioclavicular Reconstruction Surgery	Reinbolt, Jeff
219	Darren Foster	Mechanical Engineering	Dynamic Mechanical Characterization of Microscale Fibers and Thin Films	Penumadu, Dayakar
220	Benjamin Richard Kinga	Mechanical Engineering	Scintillation Properties of Lanthanum Bromide Co-Doped with Cerium and Cesium	Melcher, Chuck
221	Tyler James Newsom	Mechanical Engineering	Characterization of Void Distribution in hand layup Composite Patches using Automated Processing of Microstructure Imaging	TerMaath, Stephanie Carmella
222	Abdullah Al-Fadhili William Thomas Gerding, Quang Thanh Phung, Jacob Tyler Reed, Ian Andrew Browning, Alec Ryan Gavin	Nuclear Engineering	Advanced Control of a Three--Loop Flow System to Support Load--Following and Advanced Concepts of Operation	Coble, Jamie Baalis
223	Amanda Marie Bachmann	Nuclear Engineering	Multivariate Analysis of Gamma Spectra to Infer Used Nuclear Fuel Characteristics	Coble, Jamie Baalis
224	Lauren Ashley Finney	Chemistry	Tungsten Deposition Analysis Using Inductively Coupled Plasma Mass Spectrometry	Donovan, David

225	Kathryn Elise Bales Tyler Scott Camarena, Weston Scott Bogart, Sarah Elizabeth Creasman, Eric W Nelius	Nuclear Engineering	Use of Integrated System Sensor Detection Systems to Reduce Total Measurement Uncertainty	Walford, Graham V
226	Stephen Barush Thomas Wayne Smith, Cameron T Ubben, Zane Garrett Wallen, Cal Joseph Fosseen, Eleanor Paige Comer	Nuclear Engineering	Non-Destructive Assay of a Gaseous Diffusion Plant	Walford, Graham V
227	Zachary Reid Bingham Matthew T Herald	Nuclear Engineering	Trajectory Distortions Associated with Positron Emission Particle Tracking	Ruggles, Arthur E
228	Duncan Ryan Brocklehurst	Nuclear Engineering	Fabrication of Special Nuclear Material Ceramic Surrogates	Hall, Howard Lewis
229	Eleanor Paige Comer Zane Garrett Wallen, Thomas Wayne Smith, Cameron T Ubben, Stephen Barush, Cal Joseph Fosseen	Nuclear Engineering	Comprehensive Modeling of Holdup Deposits for Internal and External Piping Measurement Systems	Walford, Graham V
230	Asia Janell Conley	Nuclear Engineering	Southern Cooking	Hall, Howard Lewis
231	Jacob Edward Cooper	Nuclear Engineering	Structural stability of REE- PO ₄ (REE=Sm,Tb) under static pressure and swift heavy ion irradiation	Lang, Maik Kurt
232	Sarah Elizabeth Creasman	Nuclear Engineering	Improved PEPT Radiotracers Comprised of Ga-68 for Flow Diagnostics	Ruggles, Arthur
233	William Fredrick Cureton	Nuclear Engineering	Effect of Grain Size on the Irradiation Response of Actinide Oxides	Lang, Maik Kurt
234	Devon L Drey	Nuclear Engineering	Comparison of ThO ₂ and UO ₂ fuel rods using the BISON fuel performance code	Wirth, Brian David
235	James Michael Ghawaly	Nuclear Engineering	Design of a Subcritical Fast Neutron Source for UTNE	Hines, Wes
236	Joshua James Gurka	Nuclear Engineering	Characterization of Surrogate Alloys for Special Nuclear Material Forensic Applications	Auxier II, John David
237	Igor Maximovich Gushev	Nuclear Engineering	Study of temperature effect on cation inversion in MgAl ₂ O ₄ and NiAl ₂ O ₄ spinel using neutron total scattering.	Lang, Maik Kurt
238	Emily Hutchins	Nuclear Engineering	Quantification of Uncertainty in the Determination of Crack Growth Properties Determined from Compact Tension Testing	TerMaath, Stephanie Carmella

239	Kevin Lee Mcdonald	Nuclear Engineering	Scintillation Properties of K ₂ Sr ₂ Si ₂ :Eu ²⁺ Crystals with Various Co-Dopants	Melcher, Chuck
240	Dallas M Moser Devon L Drey, Igor Maximovich Gussev, Martha A Shields, Hsun Jui Chang	Nuclear Engineering	The Molten Salt iso-Breeder Reactor: Resurrecting and Refining the ORNL-4528 MSBR	Chvala, Ondrej
241	Austin Mullen	Nuclear Engineering	Preliminary Design for an Isothermal Gas Chromatography Apparatus for Inorganic Chlorides	Hall, Howard Lewis
242	Cody A Nizinski	Nuclear Engineering	Analysis of Synthetic Urban Nuclear Melt Glass	Hall, Howard Lewis
243	Jack James Nowotarski	Nuclear Engineering	Tungsten Isotope Analysis using Inductively Coupled Plasma Mass Spectroscopy for use in Nuclear Fusion Research	Donovan, David
244	Colton Jacob Oldham	Nuclear Engineering	Advanced Gas-Phase Separations of Organometallic Fission Products	Hall, Howard Lewis
245	Gavin Keith Ridley	Nuclear Engineering	Material Flow Controlled Molten Salt Reactor Depletion Calculations	Chvala, Ondrej
246	James N Eun	Physics	Development of Laminography Imaging Using Lab X-ray Source	Penumadu, Dayakar

College of Agricultural Science and Natural Resources				
Poster #	Student Name	Major	Title	Faculty Mentor
168	Garrett Thomas Froula David Brice Gilliam, Madison Rhett Brummitt	Biosystems Engineering	The EZ-Lift: A Mechanical Lift-Assist for Rollover Protection Structures	Ayers, Paul D
247	Michelle Untch	Animal Science	Clinical and Subclinical Mastitis Causing Pathogens in Tennessee Dairy Cattle	Pighetti, Gina
248	Andrew C Dixon	Biological Sciences	Identifying the oviposition preferences of Aedes mosquitoes	Trout Fryxell, Rebecca Tiffany
249	Christina Danielle Cowan-Banker	Biomedical Engineering	Effect of Environmental Weathering on Biodegradation of Plastics	Hayes, Douglas Gordon
250	Luke Thomas Martin	Biosystems Engineering	EVALUATION OF FOLDABLE TRACTOR ROLL-OVER PROTECTIVE STRUCTURES (ROPS) CLEARANCE	Ayers, Paul D

251	Taylor Douglas Spivey	Biosystems Engineering	Evaluation of fuel characteristics of legacy fine coal refuse	Abdoulmoumine, Nour
252	Andrew Whitaker Jacob Eric Parker, Rachael Anne Beaver, Andrew Wilson Lynch	Biosystems Engineering	Design of a Mobile Biochar Unit for On-site Conversion of Waste Biomass	Abdoulmoumine, Nour
253	Haley Ann Koziol	Environmental & Soil Sciences	Intercalation of Phyllosilicate Minerals By Tylosin: Influence of Solution and Exchange Phase Composition	Essington, Michael
254	Sarah Louise Ottinger	Environmental and Soil Sciences	Selection of mycorrhizal symbionts in response to abiotic stress and competitive interactions between <i>Poa annua</i> and <i>Juncus drummondii</i>	Henning, Jeremiah
255	Chad Carter Lamon Brett J Holden	Environmental/Soil Sciences	Effects of water cement ratio and improper handling on concrete cylinder strength	Drumm, Eric C
256	Chappel Spencer Weitzel Cameron McCormack Mackle, Casey E Goins	Environmental/Soil Sciences	Design, testing and analysis of ABS plastic model beams produced on the Pendergrass Library 3-D printer	Drumm, Eric C
257	James Jordan Bradwell	Food Science And Technology	Sorghum phenolic extracts: chemical characterization and biological activity determination	Dia, Vermont Punongba
258	Lynsey D. Jones	Food Science And Technology	BG-4, a novel bioactive peptide from <i>Momordica charantia</i> , inhibits lipopolysaccharide-induced inflammation in THP-1 human macrophages	Dia, Vermont Punongba
259	Michelle Hoang	Interdisciplinary Programs	Proof-of-Concept Study for Rapid Detection of Zika Viral RNA via DNA Biosensor	Eda, Shigetoshi
260	Zachary Outlaw Fox	Plant Sciences	Impact of legume cover crops on phosphorus cycling in organic cropping systems	Butler, David M
261	Jessica Slade Layton	Plant Sciences	Bigger targets are easier to hit: facile chloroplast genome transformation in <i>Nicotiana tabacum</i> cv. Petit Havana with giant chloroplasts.	Stewart, Neal
262	Francisco Javier Palacios Kelsey Harrell	Plant Sciences	Bioconfinement: Pollen and seed sterility in genetically engineered plants	Stewart, Neal

263	Rebecca Van Balen	Wildlife & Fisheries Science	Potential effects of engineered silver and copper nanoparticles on <i>Oncorhynchus mykiss</i>	Ripp, Steven
264	Evan J Buck	Wildlife & Fisheries Science	Acoustic Monitoring of American Woodcock	Buehler, David A
265	Jessica Martinez	Wildlife Management	Histomonas ELISA	Gerhold Jr, Richard William
332	Alexandra Maria Galaska	Chemical Engineering	Epoxy Nanocomposites with Reduced Flammability Derived From Magnesium Hydroxide-Melamine Polyphosphate Hybrids	Guo, Zhanhu

Celebration of Excellence Competition

The annual School of Music Celebration of Excellence Competition is open to all undergraduate instrumentalists, vocalists, and small ensembles.

2017 Celebration of Excellence Competition

Sunday, February 5, 2017

Natalie Haslam Music Center

Sandra J. Powell Recital Hall

WINNERS:

FIRST PLACE: Brianna Terry, Saxophone

SECOND PLACE: Meghan Mayes, Soprano

THIRD PLACE: Natalie Gregg, Flute

JUDGES:

Francis Graffeo (Executive Director, The Joy of Music School)

Carol Zinavage Shane (Past Principal Pianist/Keyboardist, KSO)

Carol Tucker (Violist, KSO)

Dr. Sean Greene (Band Director, Oak Ridge Schools)

A Song for Japan (Steven Verhelst)

Preston Abbott, Sarah Dixon, Christian McNeal (Euphoniums) and Tony

Tortora (Tuba)

Faculty Mentor: Dr. Alex Lapins

Quartette – Allegro de Concert (Caryl Florio)

Lily Ginder (Soprano Saxophone), Bernell Jones (Alto Saxophone),

AC Cabrera (Tenor Saxophone), Austin Fox (Baritone Saxophone)

Faculty Mentor: Dr. Allison Adams

Midnight Star (David Friedman)

Wesley Fowler, Vibraphone

Faculty Mentor: Dr. Andrew Bliss

Sicilienne (Pierre Lantier)

John Flores, Alto Saxophone

Faculty Mentor: Dr. Allison Adams

Vorrei (Francesco Paolo Tosti)

Jack Francis, Tenor

Faculty Mentor: Professor Andrew Skoog

Il Barcaiolo (Gaetano Donizetti)

Kate Smith, Soprano

Faculty Mentor: Professor Lorraine DiSimone

Total eclipse – Samson (George Frederic Handel)

Lee Brandt, Tenor

Faculty Mentor: Professor Andrew Skoog

Alleluia – Exultate, jubilate K. 165 (Wolfgang Amadeus Mozart)

Hannah Brown, Soprano

Faculty Mentor: Professor Marjorie Bennett Stephens

Dearest Mama – The Ballad of Baby Doe (Douglass Moore)

Meghan Mayes, Soprano

Faculty Mentor: Professor Marjorie Bennett Stephens

Der Tod, das ist die kühle Nacht (Johannes Brahms)

He's Got the Whole World in His Hands (arr, Moses Hogan)

Breyon Ewing, Tenor

Faculty Mentor: Professor Andrew Skoog

Laurie's Song – The Tender Land (Aaron Copland)

Ashlee King, Soprano

Faculty Mentor: Professor Lorraine DiSimone

Omnipresent (Andy Akiho)

Dwight Van de Vate, Steel Pan

Faculty Mentor: Dr. Andrew Bliss

Improvisation et Caprice (Eugene Bozza)

Brianna Terry, Alto Saxophone

Faculty Mentor: Dr. Allison Adams

Sonata Apassionata (Sigfrid Karg-Elert)

Natalie Gregg, Flute

Faculty Mentor: Dr. Shelley Binder

Poster Index

Students with poster numbers from 1-167 and 333 will present and be displayed on Monday, April 17 and Tuesday, April 18. Students with poster numbers from 168-332 will present and be displayed on Wednesday, April 19 and Thursday, April 20.

Student Name	Poster #
Adame, Eduardo	188
Adams, Amanda	60
Adcock, Sydney Lin	188
Affolter, Alec	216
Agee, Bryan	171
Alexander, Jayson E	1
Al-Fadhili, Abdullah	222
Allan, Emeri Kaitlin	119
Allen, William R	189
Alley, Eric Benjamin	93
Allison, Julia Laine	77
Ammerman, Lindsay	123
Anderson, Jessica	56
Anderson, Jessica	312
Anderson, Leah	165
Anthony, Hope	67
Archer, Gabriel	124
Arwood, Zachariah Levi	190
Auge, Madeline	43
Ayers, Darcy A	46
Bachmann, Amanda Marie	223
Bacon, Alex	147
Bales, Kathryn Elise	225
Balkon, Sarah	165
Ballard, Kimberlee Lauren	25
Barbour, Joseph Grant	2
Barker, Brandon Lynn	327
Barnes, Holli	160
Barnette, Lauren	188
Barron, Clayton	198
Barush, Stephen	229
Barush, Stephen	226
Bauer, Jennifer	293
Bauer, Jennifer	299
Beaver, Rachael	252
Beets, Jordan	5
Beets, Jordan Katherine	12
Bell, Bobby	198
Benavides, Andrea	49
Bennett, Sloan Taylor	120
Bettis, Jama	47
Bianconi, Claire	163

Bingham, Zachary Reid	227
Bittinger, Sydney Ann	26
Bivacca, Kelsey	142
Bogart, Weston	225
Bohling, John	209
Bolek, Lauren Taylor	121
Booher, Abigail Morgan	68
Boone, Caitlin Michelle	94
Boop, Sarah Elizabeth	122
Borgmier, Megan Kay	333
Borrego, Evalynn Chassity	266
Boudreau, Leegan M	217
Boullie, Kerrin	146
Boyer, Shannon	143
Brabston, Kennedy	142
Brace, Kaylee	160
Bradwell, James Jordan	257
Brasfield, Marlisa Linda	123
Bress, Kimberly Summer	309
Brito, Alexandra Claire	310
Broadbent, Curtis	171
Brocklehurst, Duncan Ryan	228
Brown, Brady	124
Brownfield, Caleb	200
Browning, Ian	222
Brummer, Chelsey	197
Brummitt, Madison	168
Buccelli, Alexandra Ruth	267
Buche, Torie	25
Buck, Evan J	264
Bueter, Tanya	124
Buffaloe, Jesse Lee	328
Burke, Madalyn	140
Burks, Robert Ethan	268
Burnett, Austin Alan	35
Burrow, Antasia	130
Callaghan, Savannah Bailey	95
Camarena, Tyler	225
Campbell, Ashley Victoria	311
Cantrell, Tiffany	60
Cantrell, Tiffany	36
Cartwright, Isabel	120
Cassetty, Hannah	141
Cassetty, Leah	29

Poster Index

Students with poster numbers from 1-167 and 333 will present and be displayed on Monday, April 17 and Tuesday, April 18. Students with poster numbers from 168-332 will present and be displayed on Wednesday, April 19 and Thursday, April 20.

Cates, Pete Michael	48
Cepeda, Rebecca Zuchowski	78
Chai, Jason	189
Chalmers, Lucia	129
Chang, Hsun	240
Charles, Dena	152
Chawla, Vivek	190
Childs, Jake Allen	218
Chin, Su Mei	121
Chistenson, Hannah	138
Choo, Esther Heewon	269
Christie, David Alexander	191
Church, Sara	121
Chwat, Carly	43
Clark, James Postell	270
Clay, Savannah	144
Clayton, Beth Anne	37
Clouthier, Shelby Taylor	312
Colclasure, Cayla Briann	38
Coles, Nicholas	52
Comer, Eleanor	226
Comer, Eleanor	229
Conley, Asia Janell	230
Conley, Austin	218
Cooper, Jacob Edward	231
Counts, Sharon	193
Cowan-Banker, Christina	249
Cox, Christina Lynn	208
Crawford, Karlie	65
Creasman, Sarah	225
Creasman, Sarah	232
Cross, Megan	152
Cureton, William Fredrick	233
Currey, Matthew	205
Curtis, Michael J	125
Dacus, Andrew	191
Dailey, Ellen	138
Daniels, Stephanie	43
Darian Andrea Frieson,	136
Darroch, Anne-Katherine K	126
Davis, Adelaide E	13
Davis, Elizabeth	65
Davis, Jenna Rae	291
Davis, Madeline M	271

Davis, Maximillian	189
Dawant, Alison	122
De Guzman, Roxanne Baker	69
Deford, Samuel	145
Denton, Ryne	191
Dilliha, Grant Thomas	179
Dixon, Jacob	169
Dixon, Jeffrey	179
Dixon, Savannah	39
Dixon, Andrew C	248
Dorris, Danika M	204
Dougherty, Rhian Victoria	127
Drake, Codi Joshua	192
Drey, Devon	240
Drey, Devon	234
Driskell, Samantha	155
Dunbar, Hannah Myers	96
Earles, Charles	61
Edens, Mark R	272
Edwards, Abigail Amina	292
Edwards, Zachary Jackson	3
Elam, Nekiaya L	273
Elbon, Rachel Christiane	27
Elliott, Logan	188
Emerson, Charles Whitley	97
Emit, Christina Haley	70
Emmanuel, Mikhail Ladhani	98
Eun, James N	246
Farrar, Taylor	189
Faust, Molly	145
Fedak, Collin Brice	293
Ferrero, lessandra Elisabetta	40
Fillauer, Jonathan	56
Finney, Lauren Ashley	224
Finotti, Christopher James	313
Fisher, Lila Holmes	171
Fitzgerald, Jacqueline	153
Flatt, Holly	49
Fortunato, Elizabeth Evan	169
Fosseen, Cal	226
Fosseen, Cal	229
Foster, Darren	219
Foster, Dylan	128
Fowler, Wesley	8

Poster Index

Students with poster numbers from 1-167 and 333 will present and be displayed on Monday, April 17 and Tuesday, April 18. Students with poster numbers from 168-332 will present and be displayed on Wednesday, April 19 and Thursday, April 20.

Fox, Zachary Outlaw	260
Frankel, Tory Danielle	79
French, Leah	65
French, Miranda Morgan	294
Froula, Garrett Thomas	168
Futcher, Maraya Hope	129
Galaska, Alexandra Maria	332
Galyon, Troy N	99
Ganns, Julia	100
Garland, Julia E	130
Garson, Rachel Lynne	131
Gass, William	101
Gavin, Alec	222
Gerding, William	222
Ghawaly, James Michael	235
Ghezawi, Natasha	180
Gilliam, David	168
Gipson, Amie	193
Gleason, Palmer	167
Glynn, Kaitlin Elizabeth	181
Goins, Casey	256
Goldman, Hayley	132
Goodrick, Kyle Jackson	202
Goodwin, Grace	132
Gorman, Rachel	14
Gorrondona, Andrea M	50
Gowder, Emily	26
Gowder, Emily	33
Grant, David Leighty	274
Graves, Clint Garrison	64
Gray, Alex Ring	8
Greenlee, Leanza	51
Grimm, Matthew Johann	133
Grissom, Kelli Michelle	193
Grossman, Natalie	153
Gunckel, Kevin R	205
Gurka, Joshua James	236
Gussev, Igor	240
Gussev, Igor	237
Hajdik, Hannah	172
Hale, Cameron Russell	209
Hancock, Chelsea	167
Hansen, Sam E	4
Hardesty, Sarah	143

Harp, Nicholas Ross	52
Harrell, Kelsey	262
Harris, Denise Elizabeth	71
Harris, Gillian P	134
Harris, Taylor	122
Harris, Taylor	80
Hartman, Alexa	316
Harvey, Alisa K	15
Henderson, Kelsey	169
Herald, Matthew	227
Hermanson, Kassandra Leigh	135
Hijer, Sami	206
Hill, Holly Keeble	72
Hillstead, Kaitlyn	126
Hirt, Laura Elizabeth	102
Hoang, Michelle	259
Hodge, Blake Aaron	314
Holcomb, Hannah Ramsey	136
Holden, Brett	255
Holder, Sierra	25
Holt, Jeremiah Ray	275
Holtzclaw, Marielle Lynn	137
Hood, John	191
Hoskins, William	209
Hoskins, William	210
House, Margaret Ellen Marie	28
Howse, Kalese	206
Huddleston, John C	29
Hutchins, Emily	238
Ignacio, Peter	43
Incorvaia, Sydney	141
Ivy, Timothy	147
Jackson, Dillan Lee	178
Jacobson, Melanie	56
Jenkins, Morgan	194
Jenna Marie Duerst	135
Jenner, Elizabeth	120
Johnson, Jesse	200
Johnson, Jesse	211
Johnson, Sarah Rebecca	295
Johnson, Suzanne	155
Jones, Caleb Lester	16
Jones, Lynsey D.	258
Kilmarx, Justin Robert	174

Poster Index

Students with poster numbers from 1-167 and 333 will present and be displayed on Monday, April 17 and Tuesday, April 18. Students with poster numbers from 168-332 will present and be displayed on Wednesday, April 19 and Thursday, April 20.

Kimbro, Scott	189
King, Dallas Bailey	73
King, Taylor Leighann	103
Kinga, Benjamin Richard	220
Knowles, Erika Rene	41
Kocisko, Corey	128
Koenig, Alexandra	146
Koger, Halli	138
Koumtcheva, Anastasia	195
Kounlavong, Emily Southida	315
Kouzov, Evelyn	131
Koziol, Haley Ann	253
Krouse, Katherine	182
Kubis, Matthew R	182
Kuribayashi, Shichie	52
Lam, Haylie Rachel	276
Lamon, Chad Carter	255
Land, Robert	120
Landenberger, Bradley Ross	104
Lane, Camille	9
Lannom, Michael	293
Lannom, Michael	329
Large, Annabel Li	183
Law, Helen	308
Lawhorn, Kane Alec	296
Lawson, Ann Marie	316
Layton, Jessica Slade	261
Lazar, Malerie R	139
Lebovitz, Sarah Grace Grace	317
Ledbetter, Hannah	167
Ledbetter, Robert Paul	318
Lee, Maygen	60
Lee, Sean Patrick	196
Leonard, Madison Kathleen	278
Lester, Taryn Drew	319
Letsinger, Amanda Leigh	140
Lett, Sadie	129
Lewis, Chelsea Alia	141
Lidwin, Michael Steven	30
Lindsey, Alyssa M	212
Linn, Audrey	200
List, Rachel	30
Lohman, Johanna Grace	53
Looney, Olivia	163

Love, Lauren	129
Lovell, Lauren	121
Luong, Hung Quoc	297
Lutzak, Claire Liana Nicole	142
Lynch, Andrew	252
Lynn O'Rear, Jessie	140
Mackenzie, Heather	128
Mackle, Cameron	256
Macrae, Caroline	137
Maddux, Peyton	165
Maness, Charis	301
Martin, Fiona	54
Martin, Luke Thomas	250
Martinez, Jessica	265
Masters, Katie Marie	320
Maxie, Amanda Lynn	321
Maxwell, Ellen	151
Mccall, Sarah Douglas	143
McCarty, Macy Belle	9
McCroskey, Thomas	132
Mccullough, Mallory	151
McDonald, Darielle	136
Mcdonald, Kevin Lee	239
McGlothin, Gillian Suzanne	173
McHugh, Emily	141
Mcinnis, Kathleen Ann	81
McIntyre, Briana Kymari	144
McLain, Tucker P	105
Mcmackin, Brenna	126
Medina, Sam	200
Melton, Jeremy Lee	197
Meyer, Haleigh	130
Midgette, Camron Grey	322
Mihealsick, Sarah Ann	145
Miles, Lindsey Estellan	146
Miller, Adam Clay	106
Miller, Chase Aaron	147
Miller, Emily Jean	279
Mills, Anna Morgan	175
Miranda, Kristen	206
Mitchell, Hannah Gabrielle	55
Mitchell, John Parker	201
Mobley, Mary Margaret	107
Mohler, Lauren Scott	74

Poster Index

Students with poster numbers from 1-167 and 333 will present and be displayed on Monday, April 17 and Tuesday, April 18. Students with poster numbers from 168-332 will present and be displayed on Wednesday, April 19 and Thursday, April 20.

Moore, David	330
Moore, David	298
Moore, Margaret Jane	5
Moore, Oliver	198
Moser, Dallas M	240
Moser, Ryan	184
Mullen, Austin	241
Murr, Thomas Ryan	17
Murray, Joshua	10
Myers, Caitlin Emily	11
Myers, Casey	10
Myrick, Claire	52
Nabors, Stephanie Sharon	149
Nachtrab, Jarrod	218
Nami, Layla Elizabeth	18
Nash, Darrian Ginae	280
Nelius, Eric	225
Nelson, Alexandra Adrienne	65
Neuharth, Taylor	135
Neveau, Max Lestat	170
Newsom, Tyler James	221
Newton, Rachel	140
Nguyen, Thao Thi	281
Nill Gomez, zabella Nicole	323
Nizinski, Cody A	242
Northcutt, Ashley Nicole	82
Nowotarski, Jack James	243
Nunn, Clayton H	282
Oldham, Colton Jacob	244
Oltmann, Shana	324
O'Malley, Brenna Brigid	83
Ortiz, Bianca	42
Ossyra, Jessica Marie	185
Ott, Elizabeth D	31
Ottinger, Sarah Louise	254
Owens, Abigail Diana	84
Palacios, Francisco Javier	262
Park, Ilkyu	283
Parker, Jacob	252
Partlow, Brock Holden	56
Patel, Neel	182
Patterson, Kaitlyn	198
Patterson, Madison McKinsey	150
Patterson, Tori	146

Payne, Taylor	315
Peck, Megan	206
Pence, Megan Louise	85
Pepperman, Kathryn Elizabeth	108
Perry, Preston David	284
Petermann, Madison Anne	325
Peters, Eric Stephen	109
Peterson, Brian	132
Petschulat, Jack Westphal	19
Phillips, Emma Jon	75
Phillips, Hayley	301
Phung, Quang	222
Pike, Brianna	137
Pirie, Abigail Elisabeth	151
Pitney, Tyler David	186
Pitt, Elisabeth	131
Pittman, Whitney Lynn	86
Plese, Sierra Renee	20
Plese, Sierra Renee	21
Poarch, Sara	62
Poland, Matthew	178
Pollack, Benjamin	205
Poppert, Rachel E	148
Porter, Haley Noel	87
Poteet, Kolby	178
Powell, Grant	207
Powell, Grant	205
Puckett, Dexter Lee	88
Puleo, Roxanne	315
Qualls, Logan Michelle	299
Quillin, David	152
Raines, Hannah	127
Ramsey, Kriston	49
Rankin, Giles	200
Ray, Mollie Elizabeth	153
Reed, Jacob	222
Reynolds, Mary Grace	63
Rhea, Caroline A	154
Rhodes, Courtney	143
Richardson, Tori	289
Ridley, Gavin Keith	245
Roark, Sierra Snively	300
Roberts, Gretchen Lorena	43
Rosenfield, Malachi	191

Poster Index

Students with poster numbers from 1-167 and 333 will present and be displayed on Monday, April 17 and Tuesday, April 18. Students with poster numbers from 168-332 will present and be displayed on Wednesday, April 19 and Thursday, April 20.

Ross, Carly	137
Rozanski, Abigail Mary	110
Rule, Madeline Marie	111
Rutstrom, Daniel Joseph	213
Salonga, Kirsten	44
Salonga, Kirsten	301
Salonga, Kirsten	302
Samples, Beverly M	89
Sanabria-Sugarman, Valeria	144
Sanders, Erika Nicole	285
Sanford, Christina	193
Sarisaltik, Damla	86
Satterfield, Katherine	156
Schaftlein, Noah	214
Schaltegger, Ethan	90
Schell, Robert	283
Schmidt, Claire	198
Schofield, Elizabeth R	112
Schoondyke, Jeffrey	280
Schwartz-Micheaux, Janet	43
Schwerzler, Sabrina	215
Scott, Katie Danielle	66
Scott, Matthew Douglas	303
Seal, Elizabeth	165
Seals, Matthew Walker	203
Seaman, Sara Elizabeth	113
Seinfeld, Jason	218
Sells, Shauna Lynn	155
Sengaroun, Timothy	22
Shannon, Jerry	298
Shannon, Jerry	330
Shaw, Casey	156
Shaw, Michael	188
Sheridan, Lucas Forrest	91
Shields, Martha	240
Shult, Kate Richter	156
Simmons, Jamie	163
Skeen, Chesnea A	57
Slappy, Rachel Lynn	176
Smith, Adam	27
Smith, Chelsea V	157
Smith, Christopher	171
Smith, Harrison Taylor	114
Smith, Shelby	171

Smith, Starla Mikel	158
Smith, Thomas	226
Smith, Thomas	229
Sonnenberg, Allison Morgan	32
Southerland, Aubrey Hope	58
Sowell, Erica	156
Sparks, Anna	188
Spencer, Cole	151
Spivey, Taylor Douglas	251
Spooner, Cameron	13
Standifer, Cynthia Michele	92
Stanfield, Elizabeth Hope	59
Stanley, Rachel Leeanne	76
Stark, Phoebe Catherine	286
Steichen, Samantha Nicole	115
Steinmann, Jennifer	60
Stephens, Elise Camille	6
Stidham, Abbigail	276
Stone, Whitney Lynn	159
Stovall, Christopher	65
Sukienik, Avery N	287
Swanson, Sierra Joan	304
Swystun, Alex Taylor	305
Tang, Fangyi	189
Tannehill, Ashlee	323
Tate, Tayler Amelia	116
Taylor, Graham Colton	10
Taylor, Jacob	198
Terry, Peyton	280
Thornton, Gerald	206
Thota, Jaideep	199
Tieche, Taylor Elizabeth	306
Toney, Kierra N	60
Towe, Kelsey Brook	160
Trent, Walker Daniel	200
Troyer, Adaya Alexandra	161
Tucker, Tawayne	155
Turan, Josh	208
Tyree, Laurel Kathryn	23
Ubben, Cameron	226
Ubben, Cameron	229
Untch, Michelle	247
Van Balen, Rebecca	263
Vance, Katherine	127

Poster Index

Students with poster numbers from 1-167 and 333 will present and be displayed on Monday, April 17 and Tuesday, April 18. Students with poster numbers from 168-332 will present and be displayed on Wednesday, April 19 and Thursday, April 20.

Vanderford, Benjamin	148
Vanmaaren, Victoria	43
Vantrease, Morgan Brooke	162
Varriano, Louis James	331
Vuong, Richard	326
Walker, Natalie	131
Wallen, Zachary	189
Wallen, Zane	226
Wallen, Zane	229
Ware, Carolyn R	288
Ware, Sallie	124
Waterson, Kelsey	39
Watkins, Amy Marie	163
Watts, Leslie	122
Weiskittel, Taylor	182
Weitzel, Chappel Spencer	256
Welch, Brooke M	289
West, Katherine	315
Whitaker, Andrew	252
White, William Wesley	45
Whited, Lauren Ashley	164
Wilbanks, Brandon	182
Wilbanks, Brandon	187
Wilder, Haley	289
Williams, Cassandra	148
Wilson, Angus	198
Wilson, Jordan	136
Wilson, Kathleen Krenson	165
Windham, Ian Andrew	290
Winfield, Jonathan William	33
Winstead, Rachel	305
Wood, Makenna Breann	34
Wood, Robert Seth	307
Woods, Lauren	142
Wright, Kaitlyn	289
Wright, Matthew Stephen	117
Yates, Simone	39
Yoder, Hannah G	166
Yolitz, Katherine	181
York, Sydney Mackane	167
Young, Anna Lois	177
Young, Jonathan Andrew	7
Yuan, Lian Jye	24
Zaouk, Rani Hani	118



AWARD YOUR WORK

Submit your top coursework to
The Undergraduate Awards

- enter online for free
- pan-discipline: 25 categories
- open to Class of 2016, 2017 & 2018
- win a trip to the UA Global Summit in Dublin, Ireland
- get your work published in *The Undergraduate Journal*



UA THE UNDERGRADUATE AWARDS

FIND OUT MORE AND REGISTER TODAY AT
undergraduateawards.com

